

AVT Yamaha FZ8/FZ1 NI Fender Eliminator Install Guide

1) Remove the rear seat with your motorcycle key. Remove the front seat secured by two bolts as pictured.

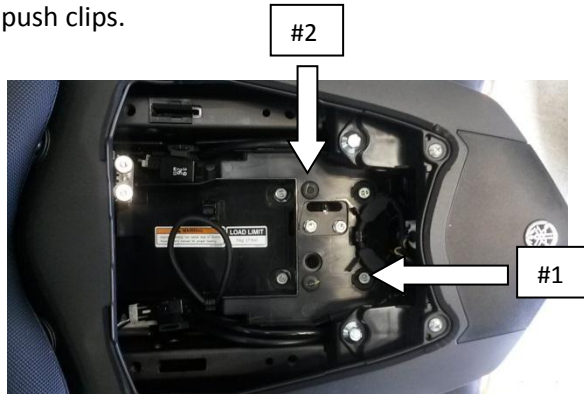

2) Loosen the OEM fender. You will need to remove: #1: (4) 13mm bolts from the top. #2 (2) push clips.



3) Trace back the wires from the fender and disconnect them.

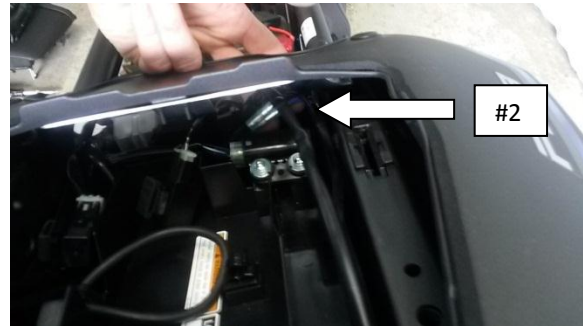
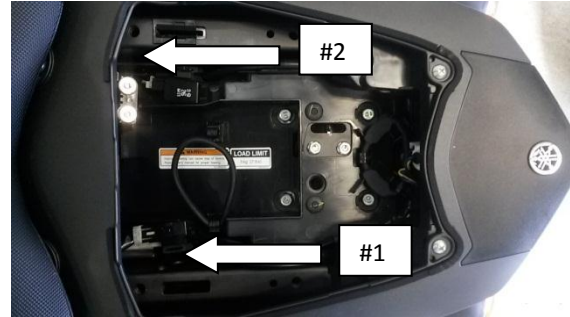

#1: One gray and one black connector.
#2 One blue and one black bullet wire connector.

Pull the wires out of the bike as you lower the OEM fender out of the way.

4) Feed the wires from your new fender eliminator through the wire opening from the bottom and attach the fender eliminator bracket with the (2) supplied 10mm bolts nuts provided. Feed the bolts from the bottom up.

5) Route the wire bundle from the fender eliminator on the left side of the bike looking from behind and connect the electric connectors: 1) red wire bullet connector to blue wire bullet connector and black wire bullet connector to black bullet connector 2) Gray plug to gray plug, black plug to black plug.

6) Reinstall your rear and front seats and license plate.

**Congratulations on successfully installing your
New AVT Yamaha FZ8/FZ1 NI Fender
Eliminator!**

Thank you for your order, AVT.



www.avt-innovations.com